

# StowAway<sup>2</sup>

## Cargo Carriers

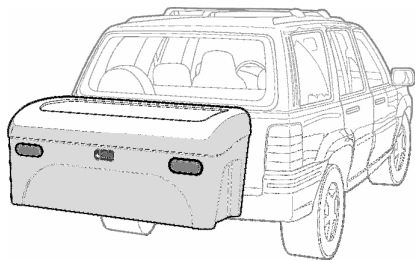

Standard Swingaway Models 022.3,  
032.3

MAX Swingaway Model 024.3

### Assembly Instructions

Rev. 0510

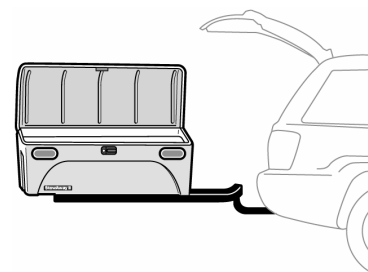

#### **Please review the instructions and safety guidelines carefully before assembling the unit**

The StowAway should be assembled and installed by two people. Assembly and installation are the end user's responsibility and beyond Pacific Recreational Product's (PRP) control. PRP limits its warranty to the repair or replacement of a defective product for up to five years from retail purchase. Damage to your vehicle, cargo, or to any person or property is excluded. Each StowAway cargo box is assembled and tested at our factory prior to shipping.

#### **Safety Guidelines when using the StowAway2**

- **EXHAUST WARNING**– Do not install the StowAway on a vehicle equipped with an exhaust system that directs the engine exhaust toward or directly under the cargo box, as damages to the box and its contents may occur. The tailpipe must direct the exhaust away from the cargo box, either downward or to the side. Exhaust tips that will direct the exhaust down or to the side are commonly available at automotive accessories stores and websites. Alternatively we offer an exhaust shield PN #020.85 that will deflect exhaust away from the StowAway Carrier. Do not install the unit on a vehicle equipped with an aftermarket exhaust system unless the exhaust tip directs the exhaust away from the cargo box. In all instances the distance between the end of the exhaust pipe and the box should be a minimum of 14 inches.
- **The StowAway Carrier is not intended for off-road use.**
- **StowAway models designed for a 2" hitch receiver should be used with a Class III or IV 2" receiver hitch. StowAway models designed for a 1.25" hitch receiver should be used with a Class II, 1.25" hitch receiver. We do not recommend the use of a 1.25" to 2" hitch converter with the StowAway carrier under any conditions.** A seven inch hitch extender may be used with Class III or IV hitches rated for more than 500 pounds tongue weight. Under no circumstances should the receiver hitch or vehicle tongue weight be exceed, nor should the vehicle gross vehicle weight be exceeded.
- When traveling with the carrier, obey posted speed limits and traffic cautions. Adapt your speed to the condition of the road, the load being carried, and the overall vehicle length with the carrier installed. For lighter or shorter wheel base vehicles it is prudent to load the StowAway with light bulky items rather than dense heavy items. Never exceed the 200 lb cargo capacity of the Stow-away carrier.
- Do not use the StowAway for transporting people, animals, or flammables. Do **not** use the carrier lid as a work or storage surface unless the unit is equipped with a lid rack. Use caution when swinging the carrier away from the vehicle and do not step on the frame when in the open position.
- Always keep the carrier's lid latched and locked when storing. Do not allow people to climb on, get into or sit on the StowAway at any time.

#### **Before driving with the StowAway2 please:**

- Make sure all knobs, bolts, screws, and locks are firmly attached, tightened and locked before every trip. Knobs, bolts, screws and locks must be periodically inspected for signs of wear, corrosion, and/or fatigue.
- Make sure that the Swingaway frame is latched and that both safeties are engaged before moving the vehicle.



# StowAway<sup>2</sup>

## Cargo Carriers

### To Assemble the StowAway<sup>2</sup> Cargo Carrier

Remove parts from cartons and confirm that all parts have been received. Save all packaging until the unit is fully assembled and functional. Contact us at (800) 943-5377 if any parts are not received.

#### **Box**

- ① 1 ea- StowAway Base (Standard or Max)
- ② 1 ea- StowAway Lid (Standard or Max)

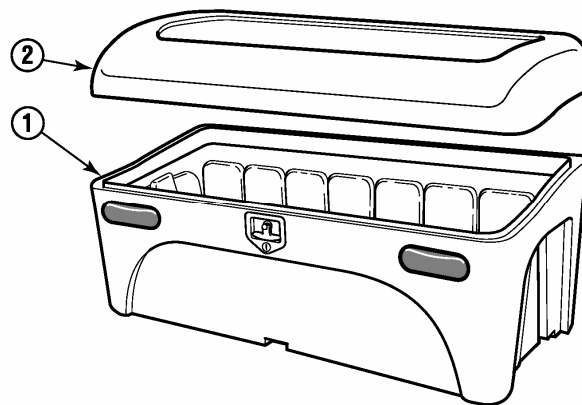

#### **Swingaway Frame**

- ③ 1 ea- Swing Arm
- ④ 1 ea- Hitch bar

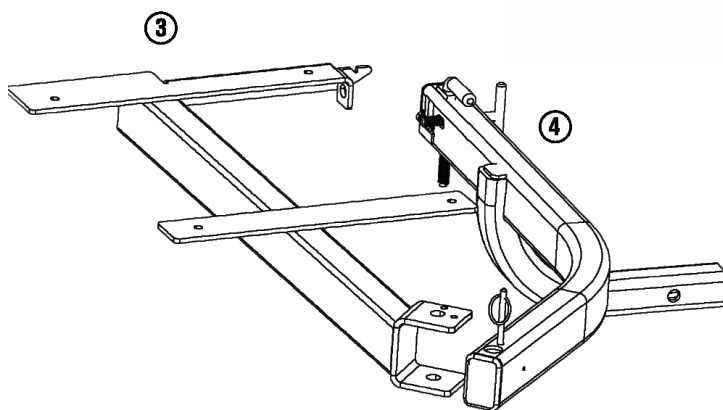

#### **Part Number 3 Note:**

Remove the swing arm from the wood backing board with 9/16" wrenches or sockets.

#### **Hardware Kit**

- ⑤ 1 ea- Drain Plug
- ⑥ 3 ea- Hinge Pins
- ⑦ 4 ea- 3/8" Bolts
- ⑧ 4 ea- Oblong Washers
- ⑨ 4 ea- 3/8" Lock Nut
- ⑩ 1 ea- 3/4" Pivot Bolt
- ⑪ 4 ea- 3/4" Flat Washers
- ⑫ 1 ea- 3/4" Lock Nut
- ⑬ 2 ea- Releasable Cable Ties
- ⑭ 1 ea- Hitch Pin (not shown)
- ⑮ 1 ea - Hitch Coupling Tightener

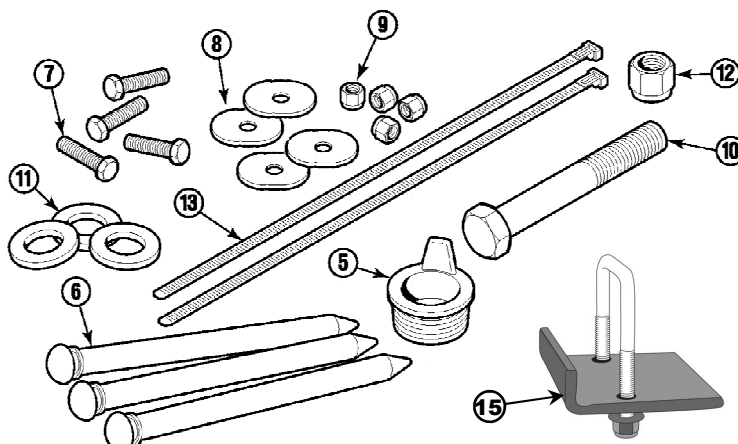

#### **Tools Required for Assembly**

Two large adjustable end wrenches or socket wrenches  
With 9/16" and 1 1/8" sockets



# StowAway<sup>2</sup>

## Cargo Carriers

### 1. Assembling the Frame

- Place the hitch bar stinger into the vehicle's receiver hitch, aligning hitch pin holes. **See Fig 1.** Locate the Hitch Pin from the hardware kit and insert it into the hitch. It is not necessary to install the hitch coupling tightener at this time unless you plan to use the StowAway immediately.
- Fit the swing arm yoke over the point of rotation on the hitch bar. **See Fig 2.** Insert two 3/4" flat washers between the yoke and the hitch bar. **This is important, as the washers are the bearing surfaces that the swing arm pivots on for smooth operation. See Fig 3.** Next, slide another 3/4" flat washer onto the 3/4" pivot bolt and push the bolt through the aligned yoke and hitch bar hole. Before threading on the 3/4" nylon lock nut, put another 3/4" flat washer on the pivot bolt (the washer should be between the yoke and the nut). **When finished you will have four washers in place on the pivot bolt; one under the head of the bolt, two between the yoke and the hitch bar and one between the nut and the yoke.** Tighten the nylon lock nut onto the pivot bolt until the swing arm swings freely, yet with light resistance. **The nut must be tightened snugly to the bottom of the yoke.**
- Test frame to ensure that the frame swings freely. **Do not attempt to latch frame at this point.**

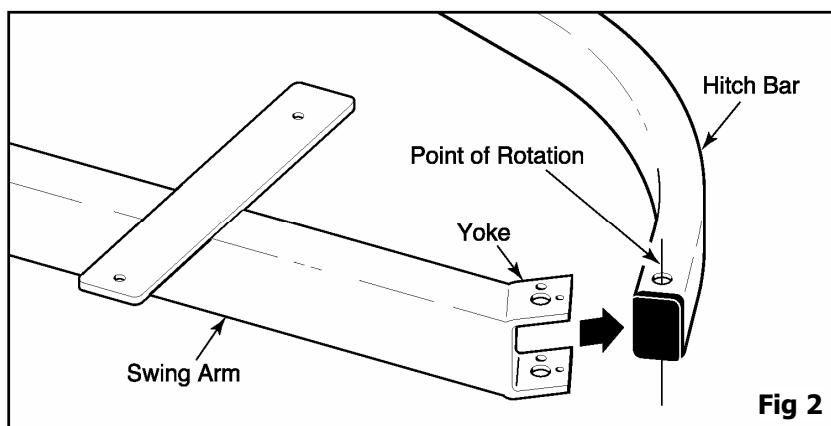
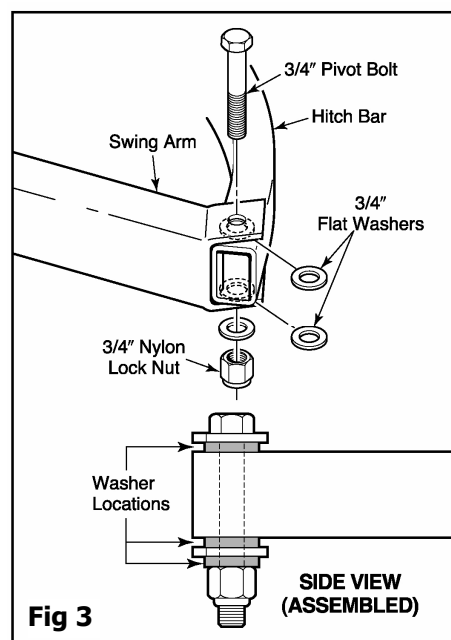
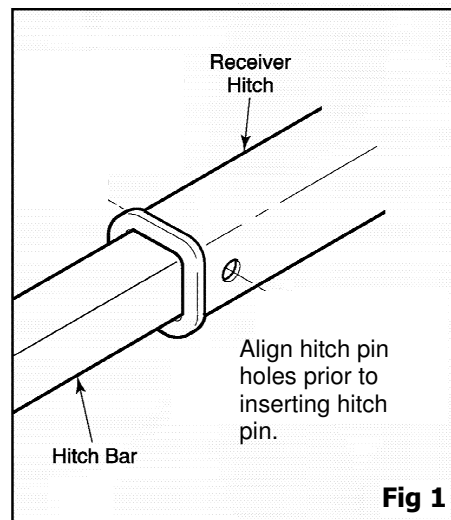

### 2. Attach Box to Frame

- Swing frame to the 90 degree position relative to the vehicle.
- Attach the box to the frame with the four bolts, washers, and nuts provided. Place an oblong washer over each hole and insert a bolt through the frame underneath. **See Fig 4.** Tighten the lock nuts onto each bolt so that they are firmly in place (it is easiest to use a socket wrench on this step).

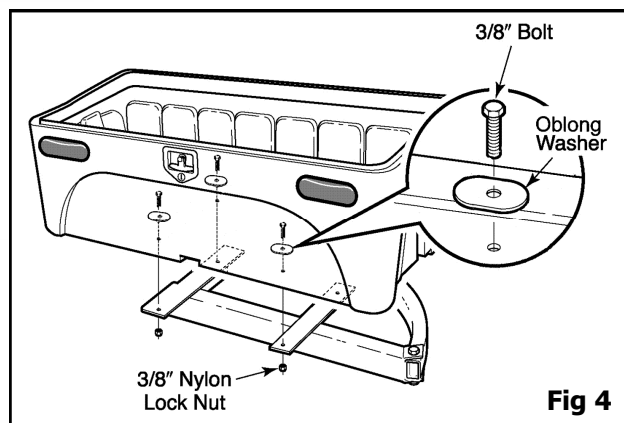

# StowAway2

## Cargo Carriers

### 3. Attach Lid to Base of Box

- Locate the nylon hinge pins.
- Position the lid on the base of the box to line up the hinge holes **with the lid in the open position**.
- Reach under the inner lip at the back of the box and push the left hinge pin into position. The pin should be pushed all the way to the hinge pin collar. Repeat this process with the right hinge pin, followed by the center pin. It will be necessary to reach under the wire harness when installing the right hinge pin. A small tool may be used to tap the pins into place if necessary.
- Locate and remove the keys from the right latch rod.
- Close the lid, press down firmly on the lid with one hand and turn the latch with the other hand. The latch rods will slide into the lid teeth bushings and engage. If your latch rods do not engage it is likely that the lid teeth have moved slightly out of alignment during shipping (temperature fluctuations can cause this.). To realign the lid teeth, face the StowAway from the front (latch side) of the box, grab and pull each of the lid teeth toward yourself with about 10–15 pounds of pressure. After holding this position for roughly 30 seconds try again to latch the box. If the latch rods still do not engage, repeat this process once again. Keep in mind that the lid fit is designed tight to inhibit water penetration to the box and that each StowAway has been fully assembled and latched at the factory before shipping. When storing the StowAway always keep the box latched to maintain the alignment of the lid teeth and latch rods.

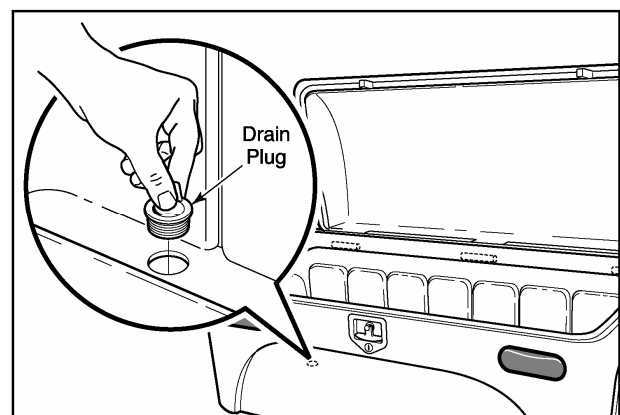
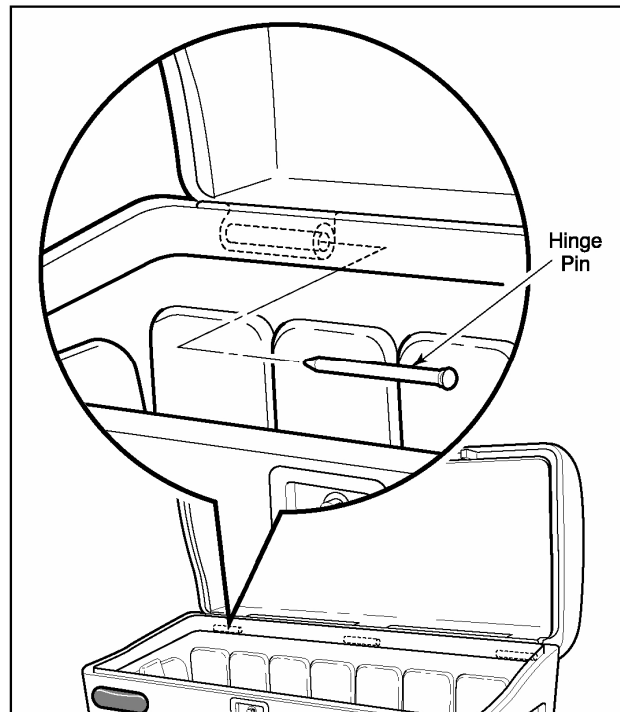

### 4. Final Assembly

- Push the drain plug into the drain hole at the bottom of the cargo box.
- Now that the cargo box is installed, test the Swingaway frame to ensure that it closes and latches properly. **It may be necessary to push down slightly on the empty carrier to ensure proper latching.** To release the frame, pull up on the plunger pin handle (pictured on Page 5).
- Pull the wire harness through the back of the box. Secure wire harness to the hitch bar with the releasable cable ties. Make sure the carrier does not pinch the wiring when swung open and shut. Adjust the harness as needed to provide adequate travel.
- Plug the wire harness into your vehicle's wire harness plug. An adapter may be required for your particular vehicle. If your vehicle is not equipped with the appropriate adapter, one may be acquired through your local dealer, auto parts supplier, through us at [www.stowaway2.com](http://www.stowaway2.com) or by calling 1.800.943.5377.
- Check lights to ensure that they are working properly.

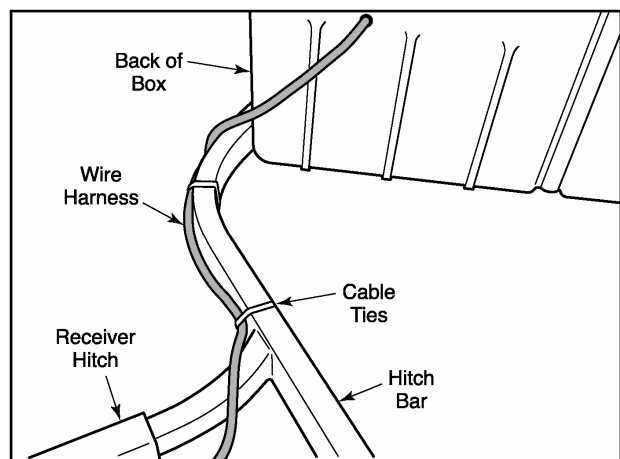

# StowAway2

## Cargo Carriers

### 5. Using the Stowaway2

Always use the locking hitch tightener or appropriate hitch pin when driving with the StowAway2. The StowAway2 may obstruct the rear view of your vehicle's license plate. We encourage all owners to check local license plate requirements, which vary from state to state. For temporary or permanent mounting of your rear license plate to the StowAway2 cargo box, a license plate bracket/light is available as an optional accessory (P/N 020.7).

**To latch the Swingaway frame**, swing the cargo box toward the vehicle until the swing arm latches with the orange-handled plunger pin (effort required to close may increase as more weight is loaded into the cargo box). Next, screw the primary safety T-bolt into the swing arm nut until the T-bolt washer is flush to the frame. Be careful to keep the threads properly aligned to prevent cross-threading. Finally, drop the secondary safety pin into place near the pivot bolt. **Always ensure that the Swingaway frame is properly latched and that both safeties are fully engaged before moving the vehicle. (See Fig 1).**

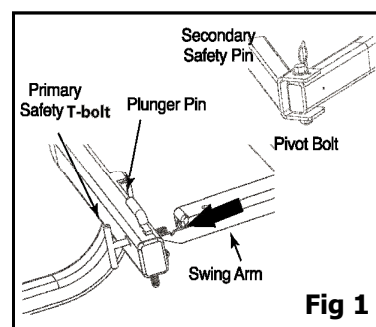

**To swing the cargo box away from the vehicle**, first remove the secondary safety pin near the pivot bolt (**See Fig 2**). Next, unscrew the primary safety T-bolt until the threads are free of the swing arm. Finally, pull up on the plunger pin handle while manually swinging the cargo carrier away from the vehicle.

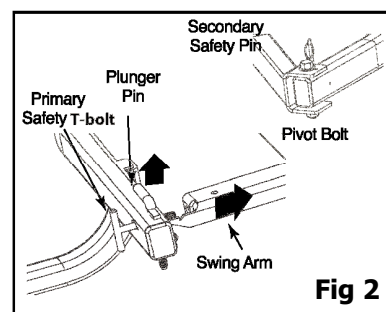

When the Swingaway frame is open 90 degrees, the secondary safety pin may be re-installed to "lock" the unit open. This is helpful when using the StowAway2 in the open position for longer periods of time or when parked on an incline.

### StowAway Usage and Care Guidelines

Care should be taken when swinging the cargo box out near traffic or on an incline. The cargo box should be loaded with the frame in the closed position if possible.

The StowAway cargo box is designed to prevent water from penetrating the interior of the box. The standard box uses a gasket for this purpose while the Max box uses a water channel and weep holes to channel water to the outside. Be sure to keep the weep holes clear of debris to ensure water drains to the outside. While these water prevention systems work effectively under most conditions, water or dust may penetrate the box in severe conditions and condensation may accumulate in the box under certain humidity conditions. Please pack your items accordingly.

The StowAway is equipped with a locking latch and security features. However, a determined thief may access the box's contents by compromising these components. Care should be taken when storing and transporting valuables in the StowAway.

The StowAway is equipped with a drain plug for ease of cleaning. The exterior surface of the cargo box can be washed with soap and water, and refreshed with Trim Shine Plastic Protectant. Trim Shine is generally available through an auto parts or accessories store.

The StowAway frame should be washed, rinsed and dried after each use to remove road grit or salt from the frame. Any sign of rust should be sprayed with rust remover/preventative at once. Moving frame components eg. the pivot bolt, plunger pins and safeties should be kept lubricated. Road salt will cause the frame to rust unless the frame is rinsed, dried and lubricated after each use.



# StowAway2

## Cargo Carriers

### 5. Using the StowAway2 (continued)

The lights are designed to provide taillight, brake light, and turn signal functionality. The lights on every cargo box are tested at the factory before shipping. If the lights do not appear to be functioning properly, please try the following steps:

- Test the unit on another vehicle. Improper vehicle wiring can be the source of carrier lighting problems.
- Check the wire connector plugs at each taillight and at the vehicle plug to ensure that each is tight and free of corrosion.
- Consult your vehicle owner's manual to ensure that the terminals on the vehicle plug match the functions of those the StowAway2 (See Fig 3).

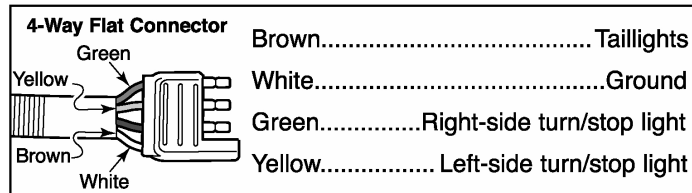

Fig 3

### Warranty on all StowAway2 Cargo Carriers

Pacific Recreational Products, Inc. warrants to the original retail purchaser of this StowAway2 cargo carrier that it is and shall remain free of defects in materials and workmanship for a period of five years from the date of retail purchase. The limited warranty does not cover normal wear and tear, rust or corrosion, or damages caused by collision, disaster, abuse, modification or misuse. Misuse includes but is not limited to overloading of the carrier, exceeding the vehicle's load capacities, exceeding the hitch receiver's load capacities, improper installation, off-road use, use with a hitch of an incorrect size and style, a sagging lid caused by placing a load on the lid without a lid rack or damage to the box from hot exhaust gas.

Limited warranty services may be obtained by first calling, emailing or writing to PRP and describing the problem or perceived defect. PRP may request documentation to fully understand the nature of the problem or defect. If a defect or problem is confirmed, PRP will, at its sole discretion, replace, repair, or authorize the return of the cargo carrier to PRP for a full or partial refund. Returns must be made to the specified address, along with the proof of purchase date, using the original shipping container or equivalent. Unless otherwise authorized, return transportation charges must be prepaid by the purchaser.

All express and implied warranties for this product, including the warranties of merchantability and fitness for a particular purpose, are limited in duration to a period of five years from the date of purchase and no warranties, whether expressed or implied, will apply after this period.

If this product is defective, the sole remedy shall be repair, replacement or refund as provided above. In no event will PRP or any of its officers, employees, or agents be liable to the purchaser for any damages, including incidental or consequential damages arising out of the use of or inability to use the cargo carrier, even if PRP has been advised of the possibility of such damages, or for any claim by another party.

Our website [www.stowaway2.com](http://www.stowaway2.com) provides a list of commonly asked questions for reference. Please contact us if you would like a copy of these for reference.

**Pacific Recreational Products, Inc.**  
7291 SW Tech Center Dr • Tigard, OR 97223  
Phone: **1.800.943.5377** • Fax: **503.968.1433**

[www.stowaway2.com](http://www.stowaway2.com)  
E-mail: [sales@stowaway2.com](mailto:sales@stowaway2.com)  
Thank you for purchasing a StowAway2 Cargo Carrier!

