

# StowAway2

## Cargo Carriers

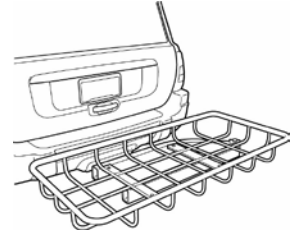

### Swingaway Cargo Rack

Assembly Instructions Rev. 1 0 1 2

Please review the instructions and warranty carefully before assembling the unit. Assembly and installation of the cargo rack are the end user's responsibility and beyond Pacific Recreational Product's control. PRP limits its warranty to the repair or replacement of a defective product for up to five years from retail purchase. Damage to your vehicle, cargo, or to any person or property is excluded.

#### Safety Guidelines when using the StowAway Cargo Rack:

- 2" hitch models should be used with Class III (or greater) 2" receiver hitches only. The maximum cargo capacity of the cargo rack is 200 lbs.
- 1.25" hitch models should be used with Class II receiver hitches only. The maximum cargo capacity of this cargo rack is 125 lbs.
- Do not exceed the rated tongue weight of the receiver hitch or the vehicle. Do not exceed the gross vehicle weight at any time. The carrier is not intended for off-road use.
- For safety to your vehicle and cargo rack, obey posted speed limits and traffic cautions. Adapt your speed to the conditions of the road, the load being carried, and the overall vehicle length with the rack installed. For lighter or short wheel base vehicles it is prudent to load the Cargo Rack with light bulky items rather than dense heavy items.
- Do not use the StowAway cargo rack for transporting people, animals, or flammables.
- Always use caution when swinging rack away from vehicle.
- Do not step on frame or place additional weight on rack when in the open position.
- Do not allow people to climb, get into or sit on the StowAway2 cargo rack at any time.

Before driving with the StowAway cargo rack installed, please:

- Make sure all knobs, bolts, screws, and locks are firmly attached, tightened and locked before every trip. Knobs, bolts, screws and locks must be periodically inspected for signs of wear, corrosion, and/or fatigue.
- Swingaway frame owners: make sure the frame is fully closed and latched before moving the vehicle. Ensure that both safety pins are engaged.

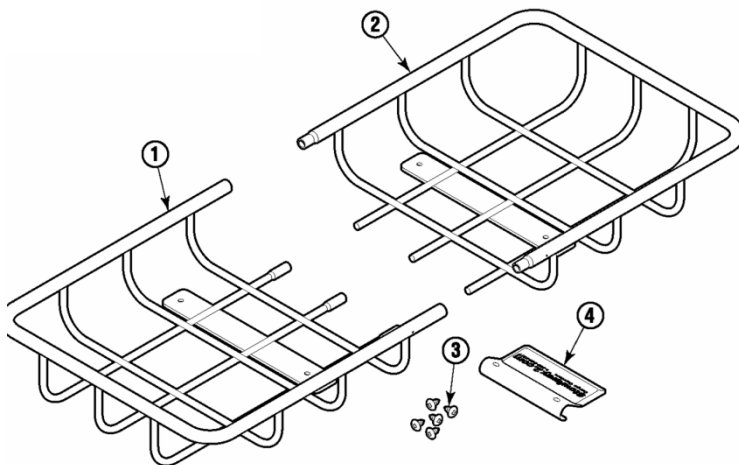

**CALL US FIRST!**

For help with assembly or missing / damaged parts, call us at

**1-800-943-5377**

Our staff will be happy to help you!

# StowAway<sup>2</sup> Cargo Carriers

## 1. Assembling the Cargo Rack

- On a smooth surface, orient the left and right sides of the cargo rack in an upside-down position. Push the two halves of the cargo rack together by carefully sliding the tubing of the right side inside the tubing of the left side. (See illustration A).
- Once the two halves are together, slight adjustment may be needed to line up the screw holes. (See illustration B).
- After the screw holes are lined up, use a Phillips screwdriver and two of the supplied screws to connect the two halves. Do not fully tighten the screws.
- Turn the cargo rack right-side up. Orient the left and right sides to find the "rear" of the cargo rack. The "rear" of the cargo rack has two small holes for mounting the name-plate on the perimeter tube. On the "front" side of the cargo rack, install another screw on the top of the perimeter tubing but do not fully tighten the screw.
- Position the rack on the StowAway frame, with the rear of the rack facing away from the vehicle, and line up the mounting holes for the rack and the frame. Insert one mounting bolt, washer and nut and partially tighten. Note: The bolt heads and washers should be on the top side of the rack and the locknuts should be on the bottom of the frame members. Re-check your mounting hole alignment, adjusting the cargo rack if necessary, and insert a second mounting bolt, washer and nut. Partially tighten. Follow with the remaining two mounting bolts and hardware and firmly tighten all bolts and nuts.
- Tighten the three small rack screws fully.
- Position the name plate on the rear center of the rack, and affix with the remaining two supplied screws. Tighten firmly. (See illustration C).

If you have also purchased a Swingaway frame, follow the instructions on the remaining pages for Swingaway frame assembly.

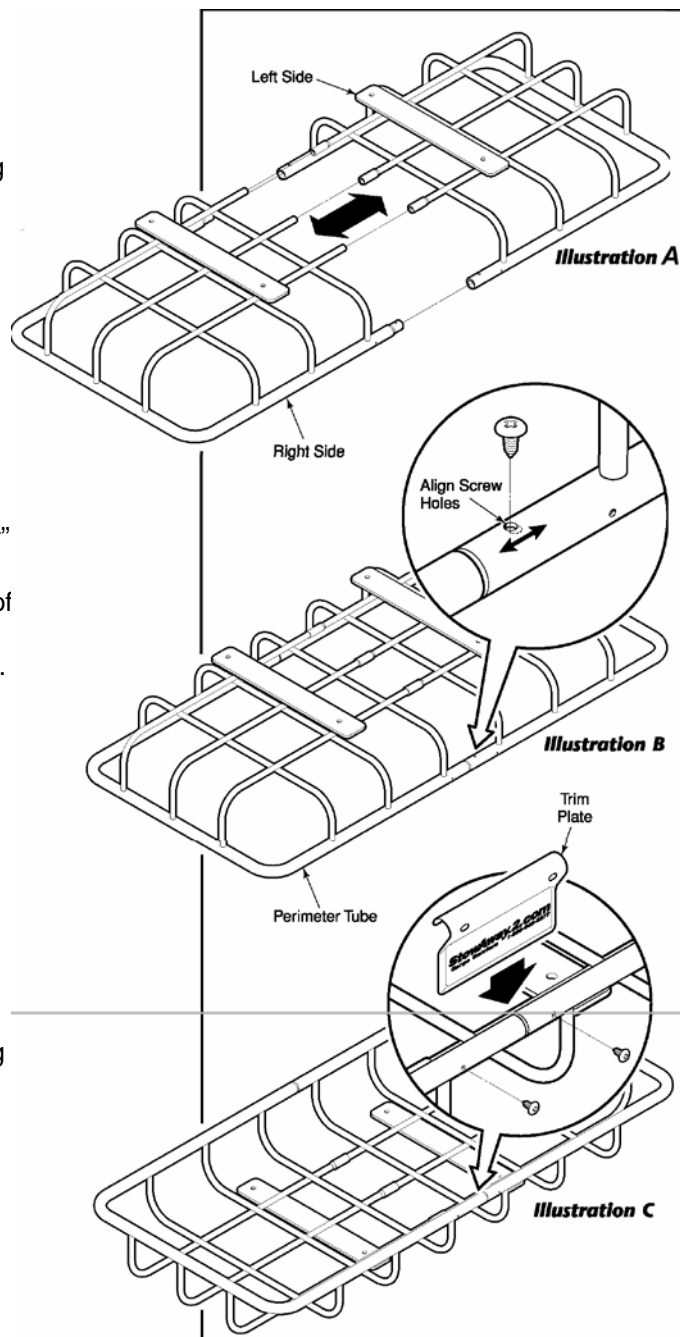

# StowAway<sup>2</sup> Cargo Carriers

## To Assemble the StowAway<sup>2</sup> Swingaway Frame

Remove parts from cartons and confirm that all parts have been received. Save all packaging until the unit is fully assembled and functional. Contact us at (800) 943-5377 if any parts are not received.

### Swingaway Frame

- 1 ea- Swing Arm
- 1 ea- Hitch bar

### Hardware Kit

- 1 ea- 3/4" Pivot Bolt
- 3 ea- 3/4" Flat Washers
- 1 ea- 3/4" Lock Nut
- 1 ea- Hitch Pin
- 1 ea- Hitch Coupling Tightener
- 4 ea- 3/8" Bolts
- 4 ea- Oval Washers
- 4 ea- 3/8" Lock Nuts

Part Number 3 Note:  
Remove the swing arm from the wood backing board with 9/16" wrenches or sockets.

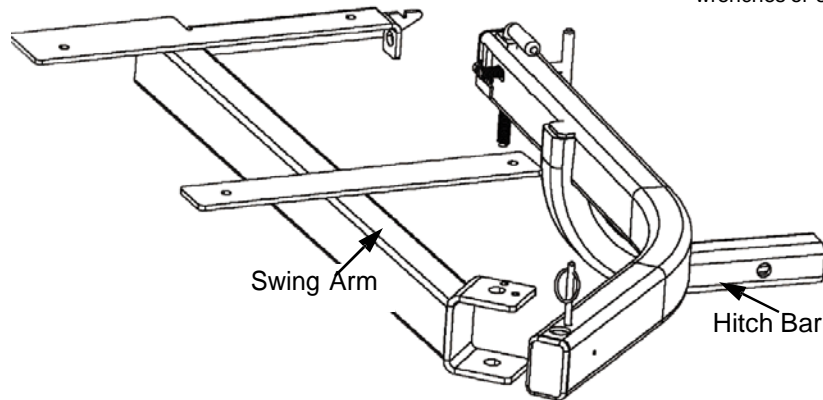

### Tools Required for Assembly

Two large adjustable end wrenches or socket wrenches with equivalent sockets

### 1. Assembling the Frame

- Place the hitch bar stinger into the vehicle's receiver hitch, aligning hitch pin holes. See Fig 1. Locate the Hitch Pin from the hardware kit and insert it into the hitch. Although the hitch tightener is shown in Fig 1 it is not necessary to install it at this time unless you plan to use the StowAway immediately.
- Fit the swing arm yoke over the point of rotation on the hitch bar. See Fig 2. Locate the four large flat washers. Position the top two washers as shown in Fig 3 and insert the pivot bolt through the yoke and the hitch bar. If you have room, locate the third washer between the bottom of the hitch bar and the yoke, as shown in Fig 3. If you do not have room, leave this washer out. Add the fourth washer to the end of the pivot bolt after it has pushed through the bottom of the yoke. Tighten the nylon lock nut onto the pivot bolt until the swing arm swings freely, yet with light resistance. The nut must be tightened snugly to the bottom of the yoke.
- Test frame to ensure that the frame swings freely.
- At this point you will want to swing and latch the frame so that you can mount the StowAway box or rack. The frame is welded so that the swingarm spear latches smoothly when the box is loaded. When the box is unloaded or not yet installed the spear may contact the tube above the hole in the hitch bar when swung closed. If you experience this contact simply push down on the swing arm as you swing it closed.

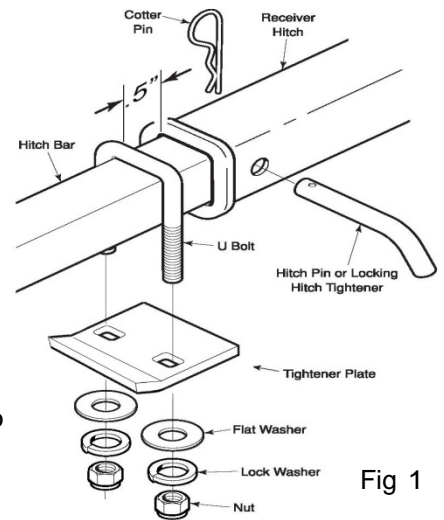

Fig 1

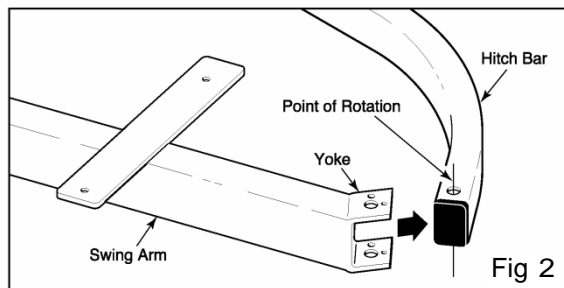

Fig 2

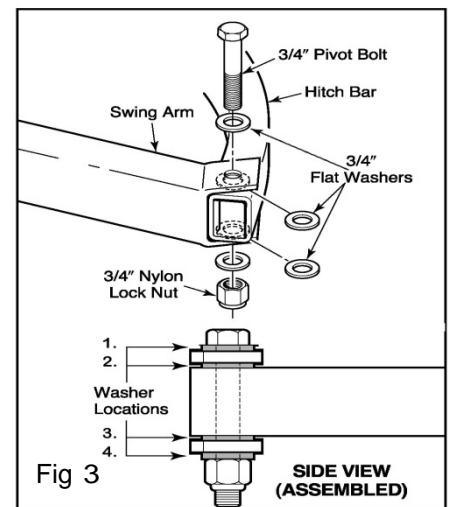

Fig 3

SIDE VIEW (ASSEMBLED)



## 2. Using the Cargo Rack

Always use the locking hitch tightener or appropriate hitch pin when driving with the StowAway Carrier.

To latch the Swingaway frame, swing the cargo rack towards the vehicle until the plunger pin latches swing arm shut (effort required to close may increase as more weight is loaded onto the cargo rack). Next, screw the primary safety T-bolt into the swing arm nut until the T-bolt washer is flush against the frame. Be careful to keep the threads properly aligned to prevent cross threading. Finally, drop the secondary safety pin into place near the pivot bolt. Always ensure that the Swingaway frame is properly latched and that both safeties are fully engaged before moving the vehicle. (See Fig 1.)

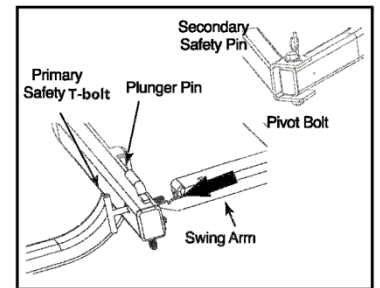

FIG 1.

To swing the cargo rack away from the vehicle, first remove the secondary safety pin near the pivot bolt (See Fig 2). Next, unscrew the primary safety T-bolt until the threads are free of the swing arm. Finally, pull up on the plunger pin handle while manually pushing the cargo rack away from the vehicle.

The Swingaway frame will lock open at 90 degrees by placing the secondary safety pin into the second hole in the yoke. This is helpful when using the carrier for tailgating or when loading or unloading the back of your vehicle.

Care should be taken when swinging the cargo rack out near traffic or on an incline to avoid hitting anyone nearby or damaging your vehicle or rack. The cargo rack should always be loaded in the closed position.

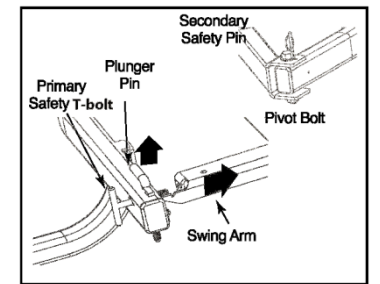

FIG 2.

### Warranty

Pacific Recreational Products, Inc. warrants to the original retail purchaser of the StowAway cargo rack that it is and shall remain free of defects in materials and workmanship for a period of ten years from the date of retail purchase.

Should the purchaser discover a defect and notify PRP during the warranty period, PRP will, at its option, repair or replace the unit at no additional charge, or refund all or part of the customer's original purchase price. The limited warranty does not cover damages caused by collision, disaster, abuse, modification or misuse. Misuse includes but is not limited to overloading of the carrier, exceeding the vehicle's load capacities, exceeding the hitch receiver's load capacities, improper installation, off-road use, or use with a hitch of an incorrect size and style.

This warranty does not cover rust or corrosion to the frame or hardware caused by moisture, salted roads or exposure to a salt air environment. To inhibit rust or corrosion caused by these factors, the frame and hardware should be rinsed clean after each use, dried thoroughly and all hardware coated with WD40, light oil or a similar rust inhibitor.

Warranty services may be obtained by contacting PRP at the contacts shown on [www.stowaway2.com](http://www.stowaway2.com) and describing the situation. PRP may request images or documentation to fully understand the nature of the problem or defect. If a defect or problem is confirmed, PRP will, at its sole discretion, replace, repair, or authorize the return of the cargo carrier to PRP for a full or partial refund. Returns must be made to the specified address, along with the proof of purchase date, using the original shipping container or equivalent. Unless otherwise authorized, return transportation charges must be prepaid by the purchaser.

All express and implied warranties for this product, including the warranties of merchantability and fitness for a particular purpose, are limited in duration to a period of ten years from the date of purchase and no warranties, whether expressed or implied, will apply after this period.

If your StowAway product is defective, the sole remedy shall be repair, replacement or refund as provided above. In no event will PRP or any of its officers, employees, or agents be liable to the purchaser for any damages, including incidental or consequential damages arising out of the use of or inability to use the cargo carrier, even if PRP has been advised of the possibility of such damages, or for any claim by another party.